

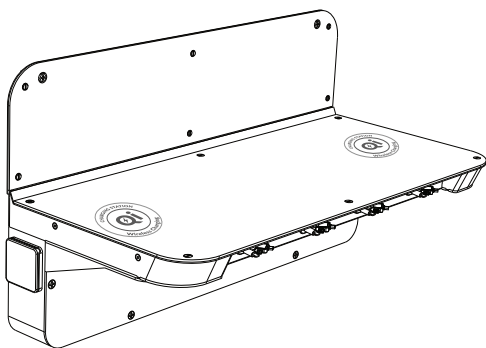

DISPLAYS2GO

Wall-Floor Charger Rapid

SKU: CHRWLRAPCP



SKU: CHRFLRAPCP

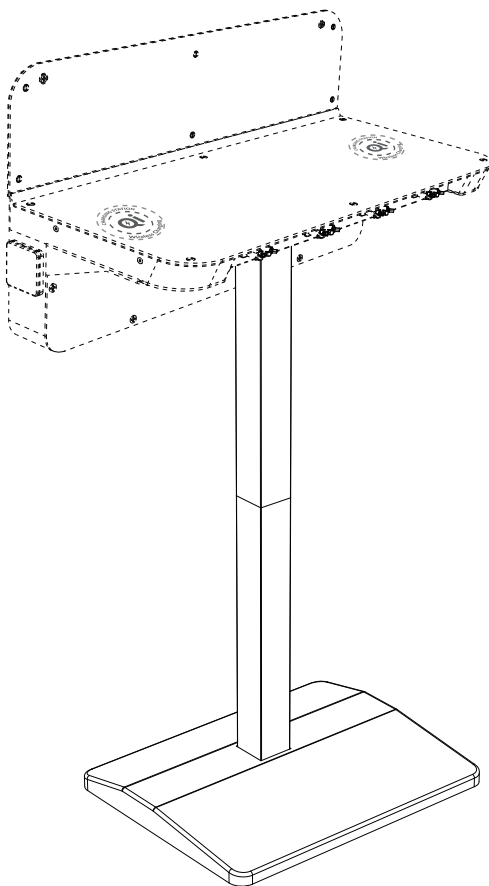

Scan QR code to visit
the product page:



Contents

A. Description and Function	2
B. Intended Use	2
C. Package Contents	2
D. Safety Instructions	2
E. Wall Mount (CHRWLRAPCP)	3
F. Replace Charging Cord	4
G. Floorstanding (CHRFLRAPCP)	6
H. Care, Maintenance, Storage and Transport	7
I. Specifications	7

A. Description and Function:

The Wall-Floor Charger Rapid is perfect for short term mobile multi-taskers or a connection space for focused tasks. It can charge 10 devices simultaneously.

B. Intended Use:



This product is for indoor use only in a dry area. Do not position in any location near water. Positioning this product outside, or inside in a location near water may cause damage or injury to persons or property. Please ensure you carefully read and abide by the 'Safety Instructions'.

C. Package Contents:

- 1pc Power Wall-Floor Charger Rapid
- 1pc Advertising Board
- 1pc Power Cord
- 1pc L Socket Wrench
- 1pc Hex Key Wrench
- 1pc User Manual
- 1set Screw (A)
- 1set Expansion Bolt (B)
- 1set Expansion Bolt (C)

D. Safety Instructions:



WARNING!

We recommend a skilled electrician is used to assemble and disassemble the housing of the product to avoid risk of electric shock or electrical damage to the product.

- This product is not a toy and should not be used by children at any time. It contains small parts which can be swallowed and cause serious injury or death.
- Ensure the product is assembled and installed in a way that prevents a person tripping over the power cable or the unit falling from its location.
- Do not install in an area with high temperature, high humidity or areas where the charging station may come into contact with water.
- Do not install near air conditioners, or in areas with excessive dust, smoke or vibration.
- Do not modify or alter the product in any way.
- Do not use the product, or any parts, if they are damaged.
- All cables and adapters should be connected and disconnected slowly and carefully.
- Ensure suitable packaging for transport of the product based on its 'Specifications'.

E. Wall Mount (for CHRWLRAPCP ONLY):

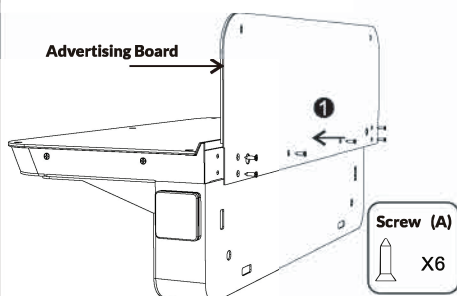

- 1** Place the graphic behind the advertising board. Attach the advertising board to charging station with 6X screws (A).

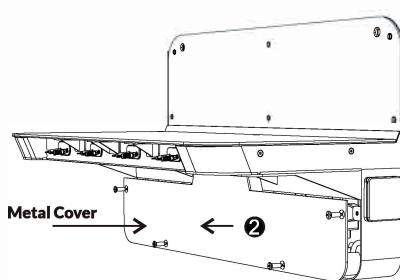

- 2** Remove the 4x screws and remove the Metal Cover.

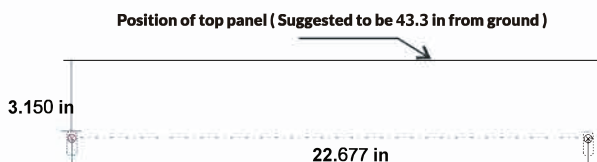

- 3** Drill 2x $\varnothing .5 / 3.15$ in holes according to the above drawing.
4 Insert 2x Expansion Bolts (B) into the holes.

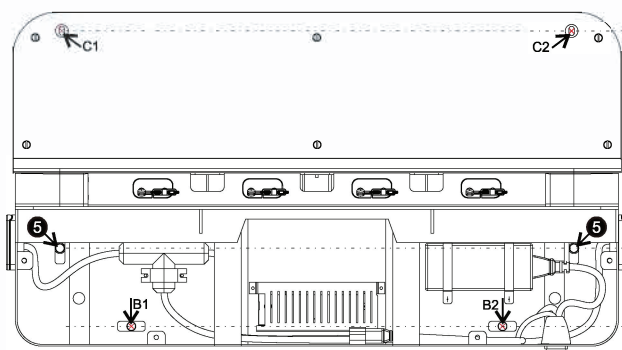
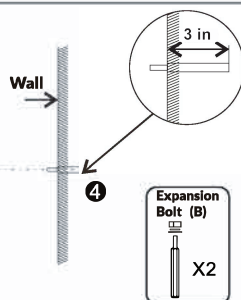

- 5** Hang the workstation on to the Expansion Bolt (B). Mark screw holes position B1,B2,C1,C2.
6 Remove workstation. Drill 2x $\varnothing .5 / 3.15$ in holes at position B1 & B2. Drill 2x $\varnothing .314/1.5$ in holes at position C1 & C2.
7 Fix 2x Expansion bolts (B) into B1 & B2, and put Plastic Plug into C1 & C2.

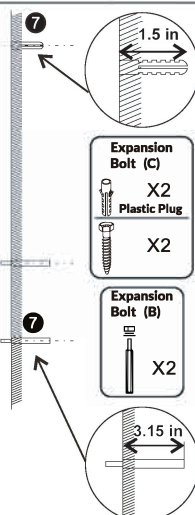

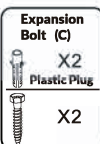
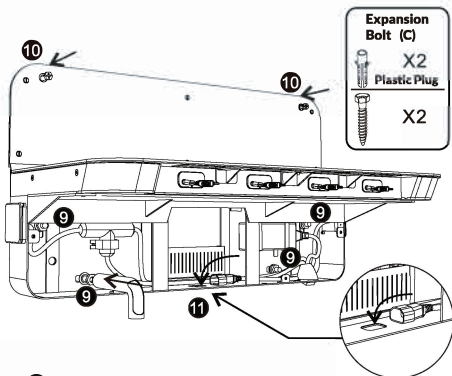

- ⑧ Hang the workstation back up.
- ⑨ Fix 4x Nuts with the L Socket Wrench.
- ⑩ Fix Expansion Bolts (C).
- ⑪ Insert power cord thru hole at the bottom of the charging station.

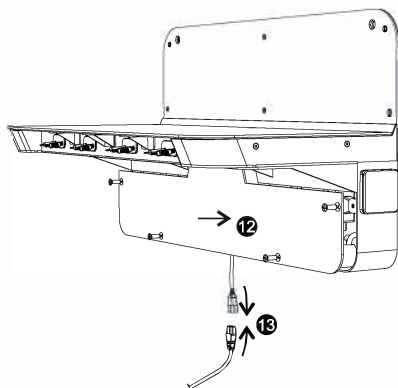

- ⑫ Secure tightly Metal Cover 4X with screws (A).
- ⑬ Connect to Power outlet.

F. Replace Charging Cable:

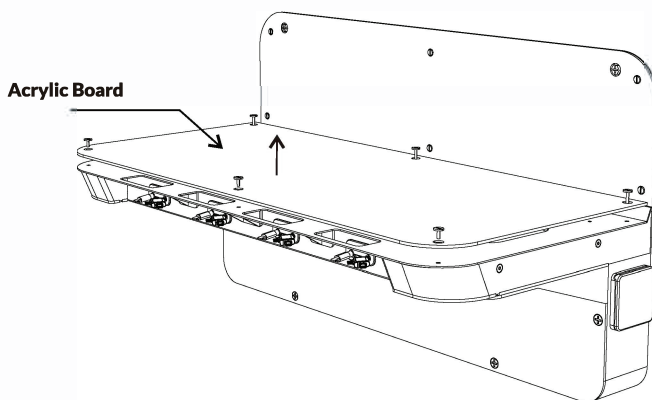

- ① Remove 6x screws and remove the Acrylic Board.

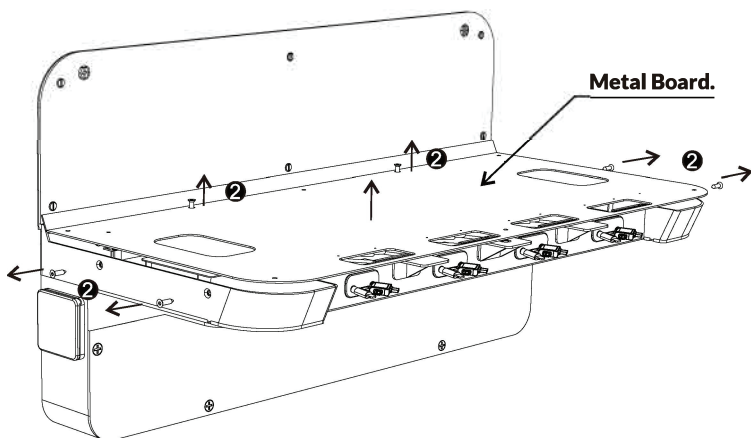

- 2** Remove the 6x screws and take off the Metal Board.

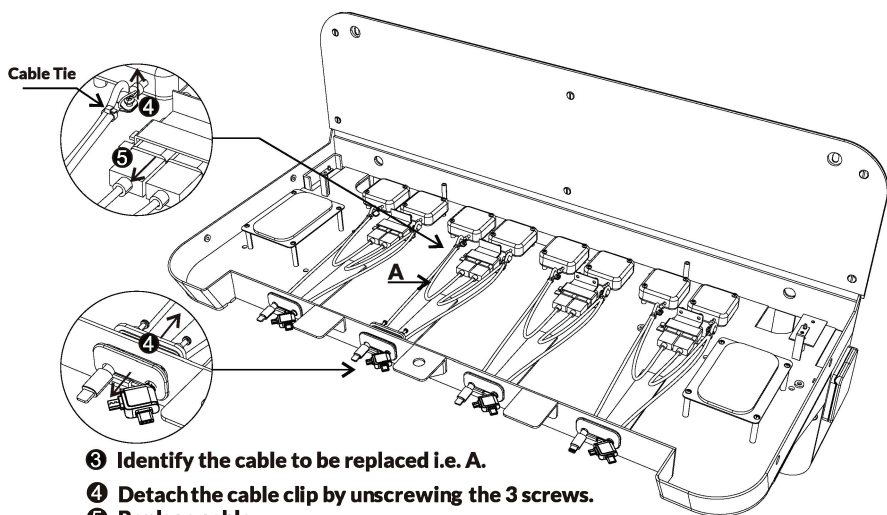

- 3** Identify the cable to be replaced i.e. A.
4 Detach the cable clip by unscrewing the 3 screws.
5 Replace cable.
6 Tighten new cable with Cable Tie and leave cable movable.
7 Replace all removed parts and screws.

G. Floorstanding (for CHRFLRAPCP ONLY):

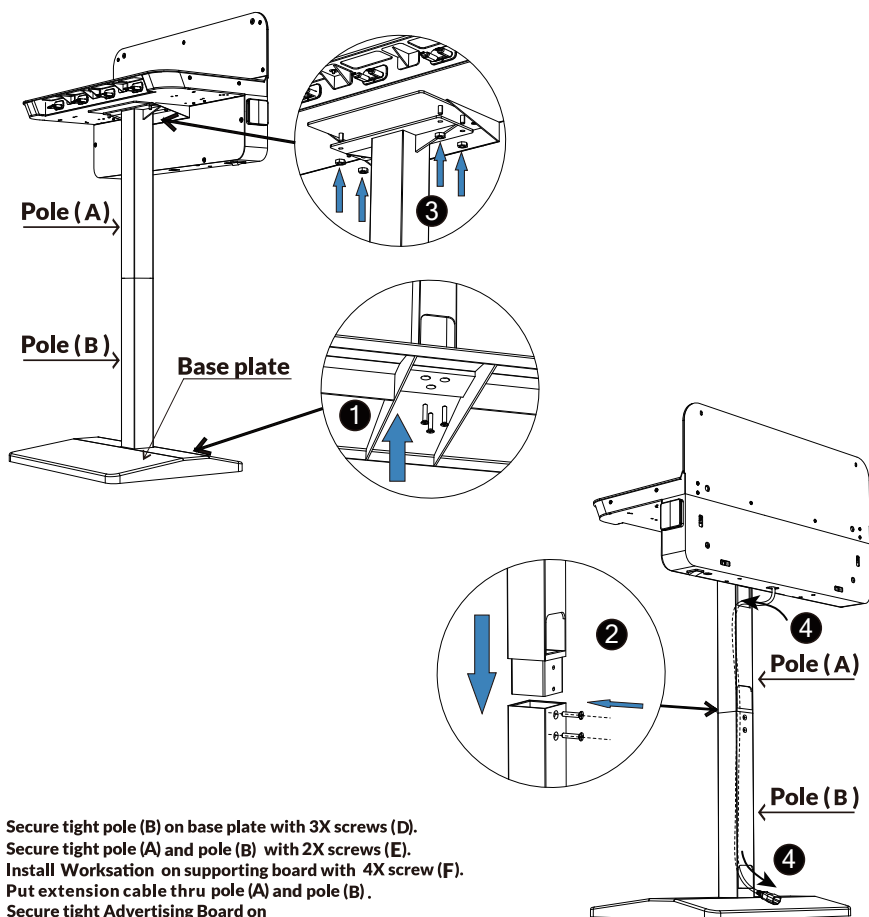

- 1 Secure tight pole (B) on base plate with 3X screws (D).
- 2 Secure tight pole (A) and pole (B) with 2X screws (E).
- 3 Install Workstation on supporting board with 4X screw (F).
- 4 Put extension cable thru pole (A) and pole (B).
- 5 Secure tight Advertising Board on charging station with screws (A) X6.

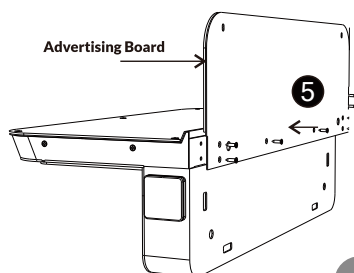
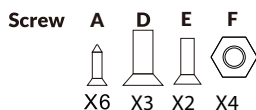

H. Care, Maintenance, Storage and Transport:



WARNING!

Please follow these instructions to avoid electric shock and/or short circuit.

- The product is self-service, i.e. users do not require assistance to recharge their device.
- Always disconnect the power cord from the main power outlet first.
- Do not clean the product until the unit is powered off and unplugged from the main power outlet. Once unplugged, clean using a dry or slightly damp cloth. Avoid using cleaning products and do not allow liquid to enter the device.
- Do not install in a location where a person could potentially trip on the power cord or the product.
- During care, maintenance, storage and/or transport, avoid places that are wet, humid or have a high temperature.
- Carefully read and abide by the Safety Instructions for care, maintenance, storage and transport.
- We recommend using the original packaging for transportation to protect the product from dust and humidity.

I. Specifications :

SKU	CHRFLRAPCP, CHRWLRAPCP
Input	110-240 Vac 50/60Hz
Output	DC: 8x 5V/2.1A
	AC: 2x 100-240V/3A
	QI: 2x 5V/1A



ATTENTION!

Please read the user manual completely and carefully. It is part of the product and includes important information for proper installation and use. Keep this guide in a safe place for reference and provide to any additional users or new owners of the product.

If you have any questions regarding our products, please visit us at www.displays2go.com or contact our customer service at 1-844-221-3388.